

Key:

- Stage 1
- Stage 1B
- Stage 2
- Stage 3
- Stage 4A
- Stage 4B
- Stage 4C
- Stage 5
- UC Under Contract
- DBL Design / Build / Lease
- Proposed Roundabout and Island

| Issue | Description | Checked | Date | Date | Scale: |
|-------|--------------|---------|----------|-----------|--------------------------------|
| | Designed: | | | | 1:4000 (A3 Original) |
| | Drawn: ES | | | 11.12.17 | |
| | Checked: AW | | | 26.04.19 | |
| | Job No: | | Dwg No: | Rev: | |
| | S1160 | | 1 | 91 | |

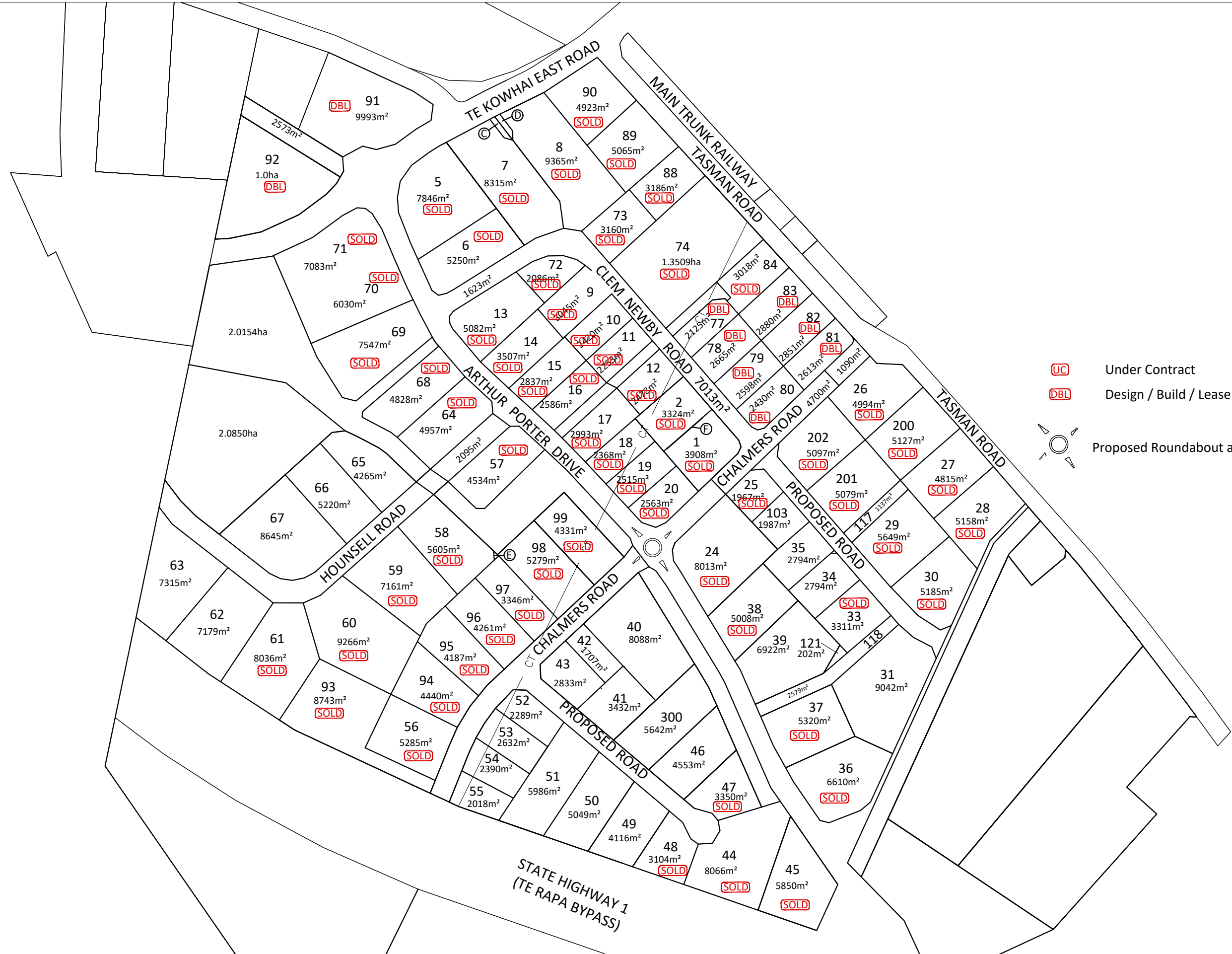

Planning | Surveying | Engineering | Environmental

Auckland Office:
 A: 25 Broadway, Newmarket
 P: 09 524 7029
Hamilton Office:
 A: 58 Church Road, Hamilton
 P: 07 849 9921
Te Awamutu Office:
 A: 103 Market Street, Te Awamutu
 P: 07 871 6144



HAMILTON JV INDUSTRIAL PARK Layout Plan

| Issue | Description | Checked | Date | Date | Scale: |
|-------|--------------|--------------|----------|-----------|--------------------------------|
| | Designed: ES | | | 11.12.17 | 1:4000 (A3 Original) |
| | Drawn: ES | | | 11.12.17 | |
| | Checked: AW | | | 26.04.19 | |
| | | Job No: | Dwg No: | Rev: | |
| | | S1160 | 2 | 91 | |

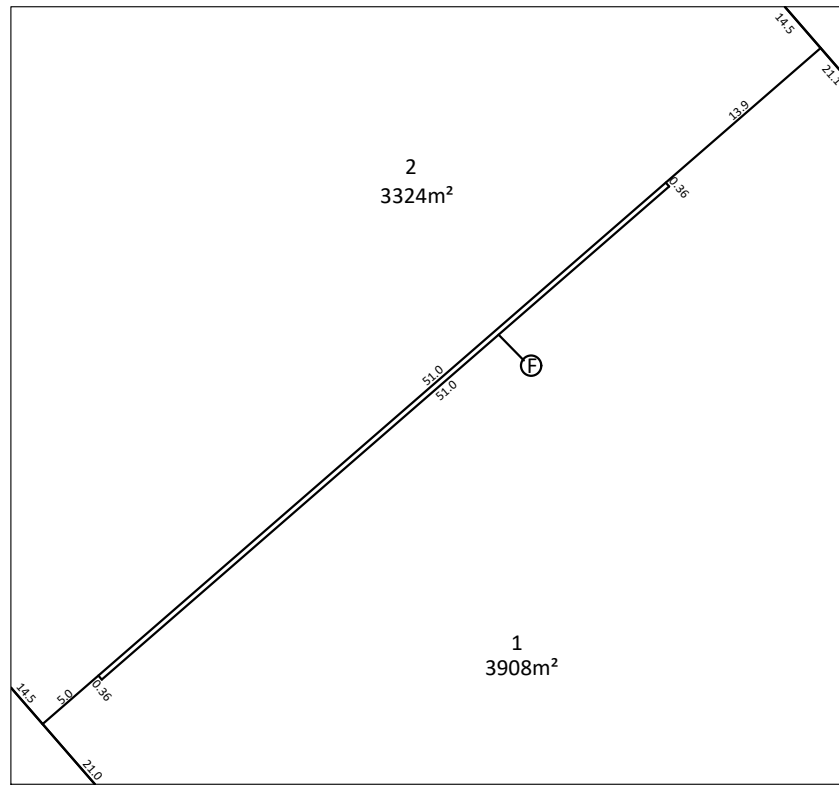

Easement F Diagram

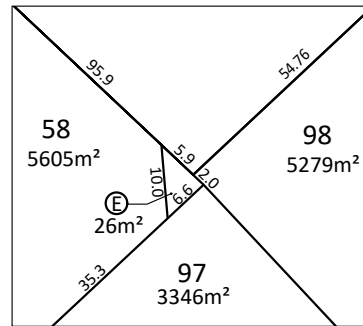

Easement E Diagram

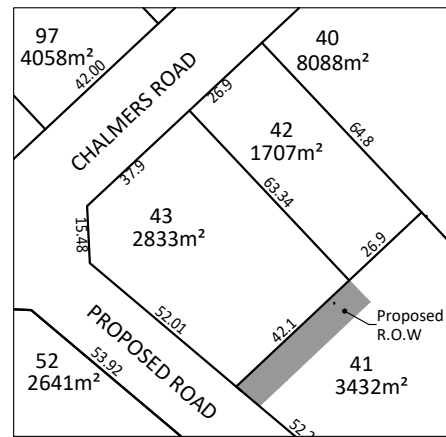

Lot 43 & 42 Diagram



Auckland Office:
 A: 25 Broadway, Newmarket
 P: 09 524 7029
Hamilton Office:
 A: 58 Church Road, Hamilton
 P: 07 849 9921
Te Awamutu Office:
 A: 103 Market Street, Te Awamutu
 P: 07 871 6144

TE RAPA HAMILTON JV INDUSTRIAL PARK

GATEWAY Site Dimensions

| Issue | Description | Checked | Date | Date | Scale: |
|-------|--------------|---------|----------|-----------|---------------|
| | | | | | 1:4000 |
| | Designed: | | | 11.12.17 | (A3 Original) |
| | Drawn: | ES | | | |
| | Checked: | AW | | 26.04.19 | |
| | Job No: | | Dwg No: | Rev: | |
| | S1160 | | 3 | 91 | |