

Key:

- Stage 1
- Stage 1B
- Stage 2
- Stage 3
- Stage 4A
- Stage 4B
- Stage 4C
- Stage 5
- UC Under Contract
- DBL Design / Build / Lease
- Proposed Roundabout and Island

Issue	Description	Checked	Date	Date	Scale:
	Designed: ES			11.12.17	1:4000 (A3 Original)
	Drawn: ES			11.12.17	
	Checked: AW			10.06.19	
	Job No: S1160			Dwg No: 1	Rev: 93

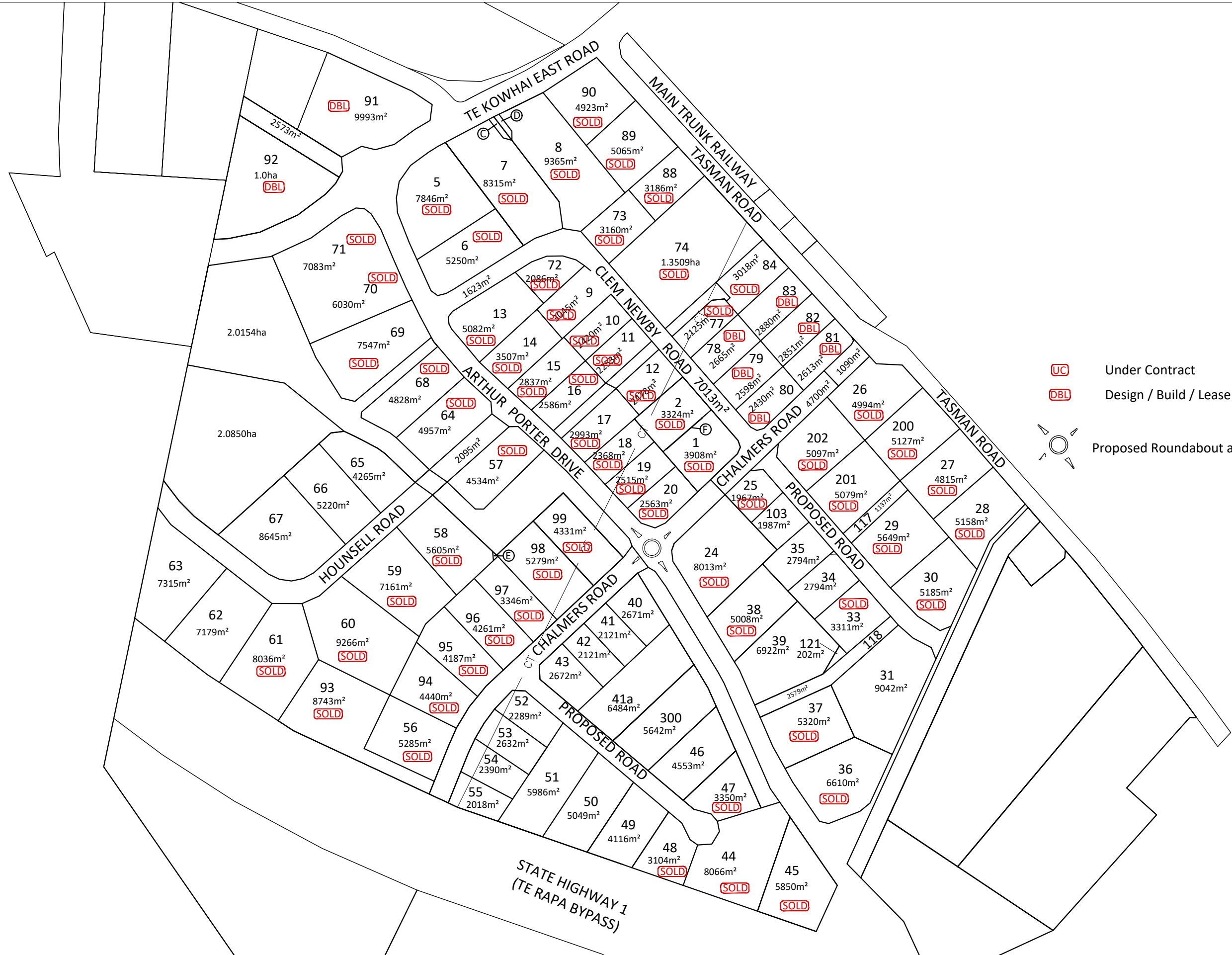

- UC Under Contract
- DBL Design / Build / Lease
- Proposed Roundabout and Island



Planning | Surveying | Engineering | Environmental

Auckland Office:
 A: 25 Broadway, Newmarket
 P: 09 524 7029
Hamilton Office:
 A: 58 Church Road, Hamilton
 P: 07 849 9921
Te Awamutu Office:
 A: 103 Market Street, Te Awamutu
 P: 07 871 6144



**HAMILTON JV INDUSTRIAL PARK
 Layout Plan**

Issue	Description	Checked	Date	Date	Scale:
	Designed: ES			11.12.17	1:4000 (A3 Original)
	Drawn: ES			11.12.17	
	Checked: AW			10.06.19	
	Job No: S1160			Dwg No: 2	Rev: 93

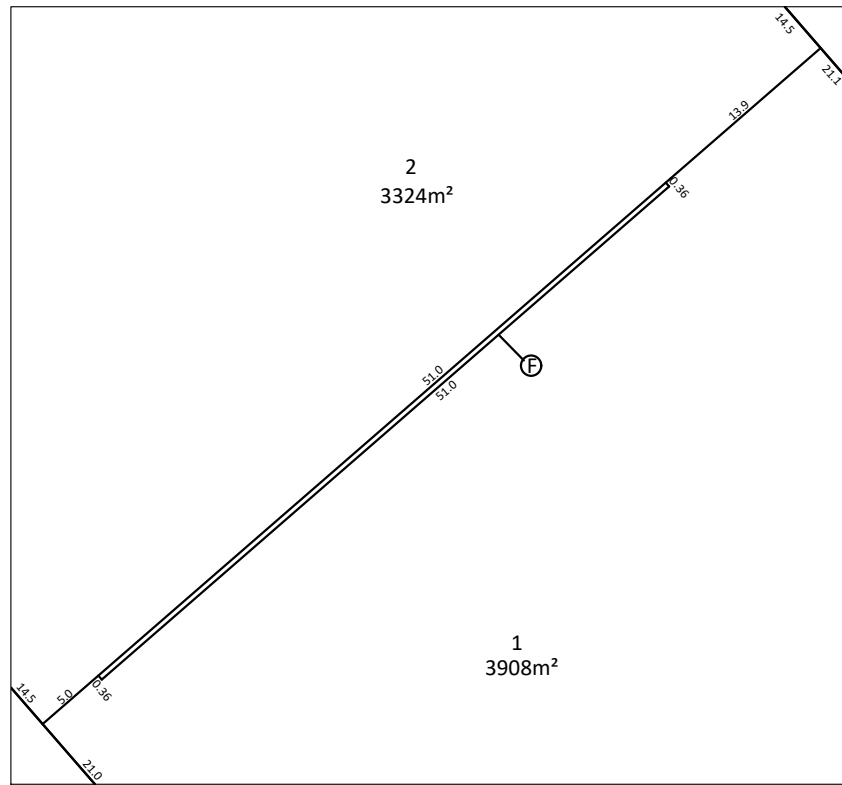

Easement F Diagram

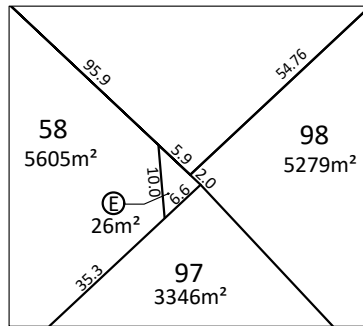

Easement E Diagram

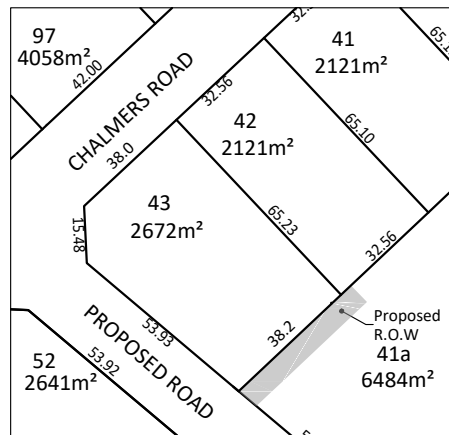

Lot 43 & 42 Diagram



Auckland Office:
 A: 25 Broadway, Newmarket
 P: 09 524 7029
Hamilton Office:
 A: 58 Church Road, Hamilton
 P: 07 849 9921
Te Awamutu Office:
 A: 103 Market Street, Te Awamutu
 P: 07 871 6144

TE RAPA HAMILTON JV INDUSTRIAL PARK

GATEWAY Site Dimensions

Issue	Description	Checked	Date	Date	Scale:
	Designed:			11.12.17	1:4000 (A3 Original)
	Drawn: ES			11.12.17	
	Checked: AW			10.06.19	
	Job No:		Dwg No:	Rev:	
	S1160		3	93	